

*Offset-Mount Videoconference Fixture*
**Construction**

Fixture housing is made of formed, cold-rolled sheet steel. Dome-shaped interior fixture housing. Perforated filler panels are optional.

**Fixture Body Finish**

Low-gloss, off-white finish (Tiger Drylac #44911704) is standard, with custom colors available.

**Fixture Carriage and Reflector**

Two sizes of lamp carriages are available, housing one or two 55-W lamps. Reflectors are of formed-aluminum specular-sheet-metal construction, featuring 95% reflectance. Direct/indirect task lights are available to provide for soft, glare-free room illumination. Wall Washer housing (one lamp) provided with reflective white finish.

**Ballast**

Ballasts are available in switched or in a variety of dimmable configurations. All ballasts are high-frequency electronic, with a Power Factor > .97, THD < 10%, and a Class A sound rating. Ballasts are housed in the fixture housing. Power and control inputs are from the side.

**Lamps**

All Brightline fixtures use 55-W compact fluorescent lamps, available in a variety of color temperatures and CRI ratings (see the Fixture Accessories and Lamps datasheet for details). Studioline and Cinema Series lamps are optimized specifically for video camera applications.

Shipping Information
Length: 28 in (711 mm)
Width: 25.5 in (648 mm)
Height: 14.5 in (368 mm)
Weight: 35 lb (15.9 kg)

**Articulation**

**Rotate:** Fixture carriage mounted on a sliding bracket allows for greater range of angular movement (+/- 50 degrees) on a single axis.

**Drop-Pan-Tilt:** Provides three axes of movement. DPT fixture carriages move up and down from the ceiling, revolve 360 degrees, and rotate angularly (+/- 70 degrees).

**Motorized:** Fixtures with motorized articulation are available in a configuration featuring a two-lamp carriage. Offers angular movement (+/- 50 degrees) on a single axis.

**Accessories**

A variety of control screens are available to shape the light-beam pattern (see the Fixture Accessory and Lamps datasheet for details). White-finish screens are standard, with black finish as an option. Prismatic lenses are available for one- and two-lamp carriages.

**Fixture Dimensions**

Inch Panel: 23.750 x 23.750 x 7.072 in  
(603.25 x 603.25 x 179.62 mm)

Metric Panel: 595 x 595 x 179.62 mm  
(23.43 x 23.43 x 7.072 in)

Fixture Weight: 22 lb (10 kg)

**Electrical Certifications**

UL, cUL, CE, and C-Tick



*Fixture shown with Two-Lamp Rotate carriage.*

US Patent No. 6,517,216. Other US and foreign patents pending.

**Sample Fixture Configurations**

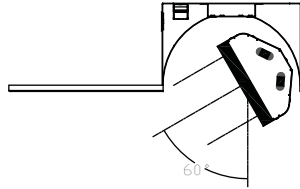

Two-Lamp with maximum right slide; includes contrast light.

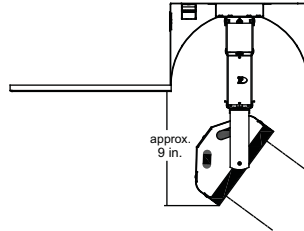

Two-Lamp Drop-Pan-Tilt (shown in dropped position and tilted).

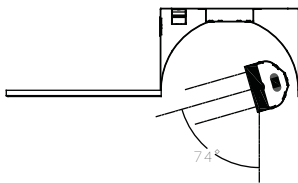

One-Lamp Rotate with maximum right slide; includes contrast light.

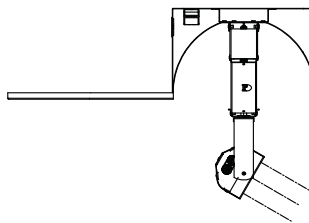

One-Lamp Drop-Pan-Tilt (shown in dropped position and tilted).

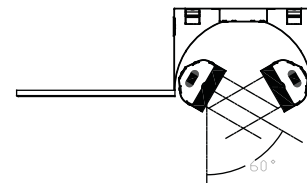

One-One-Lamp Rotate with maximum left and right slide; includes contrast light.

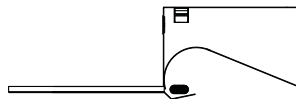

Wall Washer showing lamp and indirect reflector.

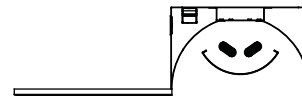

Task Light showing lamps and perforated diffusion screen.

<b>T</b>				Articulation R = Rotate & Contrast D = Drop-Pan-Tilt M = Motorized Rotate <b>OR</b> T = Task W = Wall Wash	Panel Size I = Inch Panel M = Metric Panel	Panel Style S = Solid Panel P = Perforated Panel	Mounting Style MM = Mini T CM = Center-Mount OM = Offset Mount 45 = 45-Degree Mount
	Lamp Carriage	Ballast Type	Voltage				
	01= One 1-Lamp Carriage	E = EcoSystem L = Hi-Lume N = Non-Dim	1 = 120V 2 = 230V 7 = 277V				
	11= Two 1-Lamp Carriages 02= One 2-Lamp Carriage <b>OR</b> 00= No Lamp Carriage	P = Phase X = DALI					

Note: EcoSystem Ballasts have a THD of 20%.

Note: Hi-Lume and Phase-Dim ballasts are not available in 230V.

Note: Custom Finish is available. Add a "-CF" to the end of the part number.

Note: Fixtures require Control Screens and Lamps; see Fixture Accessories and Lamps datasheet for options.